

# LED Obstruction Light Type 426

High impact and weather-resistant obstruction light according to the regulations of the Federal Office for Civil Aviation BAZL (AD I-006) as well as ICAO (Annex 14, Chapter 6). For marking **flight obstacles with low intensity obstruction lights; e.g. high-rise buildings or construction cranes.**

In this system a red light (RD) and an infrared light (IR) are installed. Thus, the system is suitable for night vision devices (NVG). The red light shines continuously, the infrared light flashes. Thanks to GPS-synchronisation, several systems flash simultaneously.

Simple clamp mounting of the light, e.g. on a tube.



## Technical Data

<b>Casing</b>	high impact polycarbonate
<b>Protection</b>	IP 67
<b>Weight</b>	1.35kg
<b>Light source</b>	LED
<b>Mounting</b>	clamped to tube
<b>Voltage</b>	12V DC 24V DC 110-230V AC
<b>Light intensity</b>	RD 12 cd red light IR > 150 mW <sub>sr</sub> Infrared
<b>Color location</b>	red light 623nm Infrared = 850nm
<b>Flash frequency</b>	red light: permanent Infrared: flashing, 20 pulses/min. 0.5s ON, 2.5s OFF

## Maximum power input

	Type 426
12V DC	220mA
24V DC	220mA
230V AC	47mA

## Execution and Accessory

<b>Execution</b>	with error monitoring with flash frequency synchronisation for multiple lights of the same system
<b>Accessory</b>	3/4" adapter twilight control, external bracket with tube and cable tie magnetic holder with safety rope marker balloon alternative flash frequencies

## Order Information

<b>Order number</b>	426-uuu-RIR-R-GPF
<b>Voltage (uuu)</b>	012 12V DC 024 24V DC 230 230V AC
<b>Color code</b>	RIR red / Infrared
<b>Monitoring</b>	R with relay contact for error monitoring
<b>Execution</b>	GPF synchronisation of flash frequency

Front view

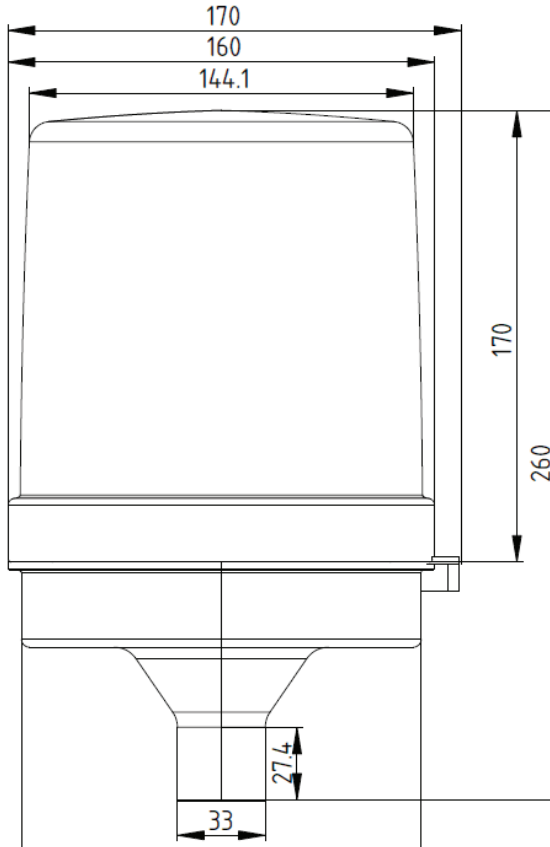

Top view

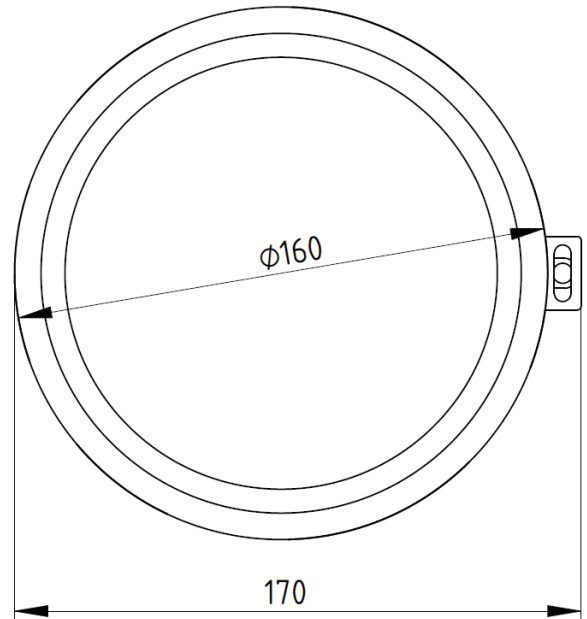

Bottom view

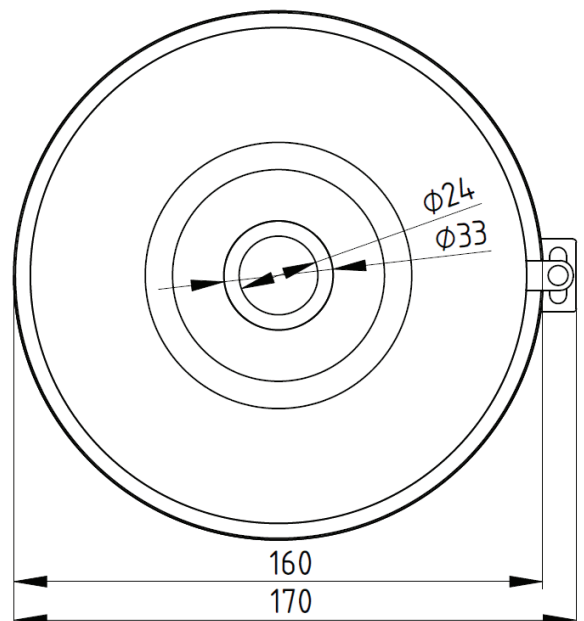

Hugentobler Spezialleuchten AG

Brunnenwiesenstrasse 14

CH - 8570 Weinfelden

Tel. +41 71 626 20 40

info@spezialleuchten.ch

www.spezialleuchten.ch



Signalling and alarm lights



Special lights for aviation and navigation



Tunnel safety lights