

LED light Type IL555D

Series IL555D LED lights are suitable for various applications on helipads and landing pads. Thanks to their extremely compact design, they can be optimally integrated into the platform structure or mounted in concrete or blacktop using a shallow base. The lights are equipped with infrared LEDs, making them compatible with night vision goggles (NVG).

It is characterised by low energy consumption and greatly reduced maintenance frequency. Under normal operating conditions, the LEDs have a service life of >80,000 hours.

There is a choice of two designs:

1. Full-Flush (FF): completely embedded in the ground and therefore suitable for snow clearing. Limited omnidirectional distribution.
2. Semi-Flush (SF): above ground, omnidirectional and ICAO-compliant.

Technical Data

Casing	Aluminium
Glass	Borosilicate, tempered
Protection	IP68
Weight	0.8kg
Source of light	LED
Light color	green, white, blue (as per ICAO Annex 14 Volume II Heliports) red, yellow (as per FAA EB98)
Temperature	-35°C to +50°C
Voltage	24V DC
Mounting	using 4x M5 countersunk screws
Connection	using connection box
Connecting cable	rubber cable, oil-resistant, 3x1mm2 brown = +24V, blue = GND, black = Dimming
Dimming	5% to 100% dimmable (10 - 0V)

Power input

	15W (white)	< 6W (other)
24V DC	625 mA	< 250 mA



Execution and Accessory

Execution	Full-Flush (suitable for snow-cleaning) oder Semi-Flush (ICAO-compliant)
Options	Execution DALI Casing made of stainless steel
Accessories	Floor mounting shallow base Adapter ring to 8" shallow base Connection box

Order Information

Order number	IL555D-vv-024-c
Version (vv)	FF full-flush (suitable for snow cleaning), limited omnidirectional distribution SF semi-flush, omnidirectional (ICAO)
Voltage	024 24V DC
Light color (c)	G green (TLOF) W white (FATO Aimingpoint etc.) B blue (Taxiway) R red (Perimeter Light) Y yellow (Perimeter Light)

Both designs

Top view

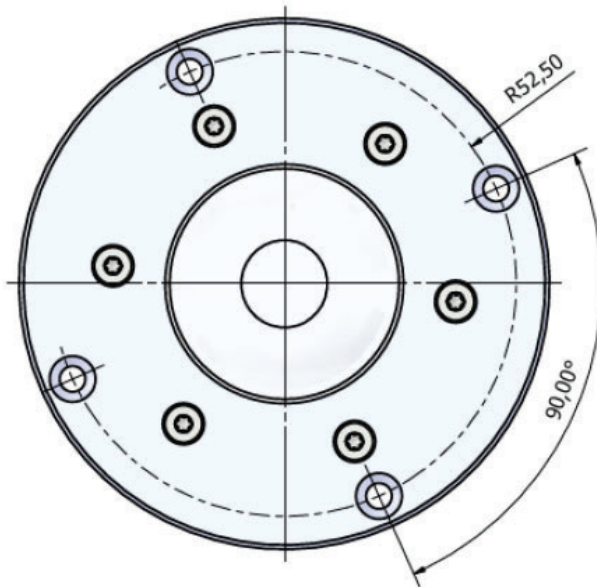

Full-Flush design (suitable for snow clearing)

Side view

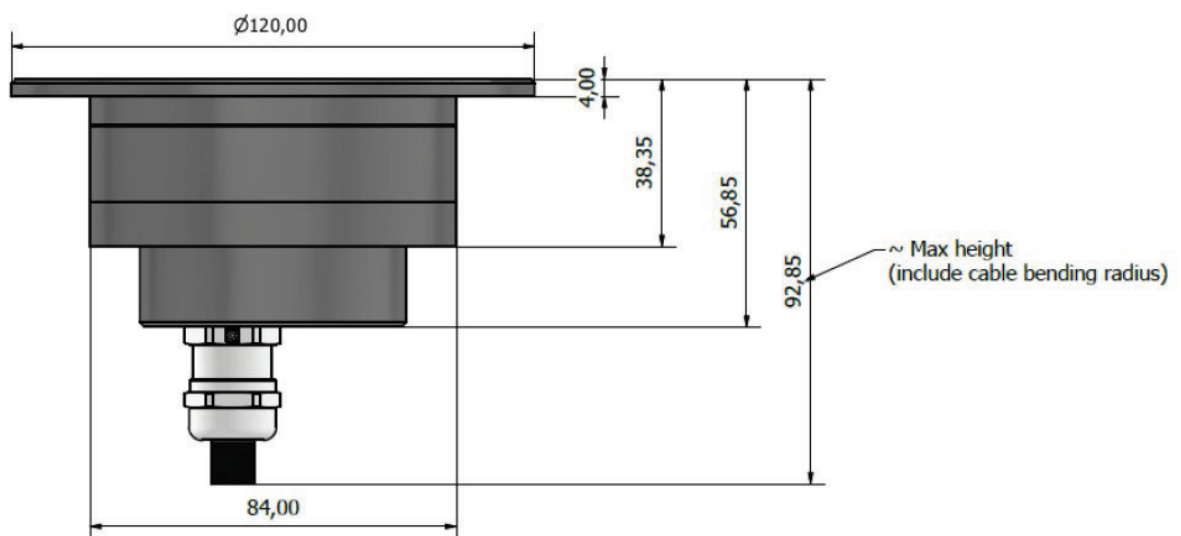

Semi-Flush design (ICAO)

Side view

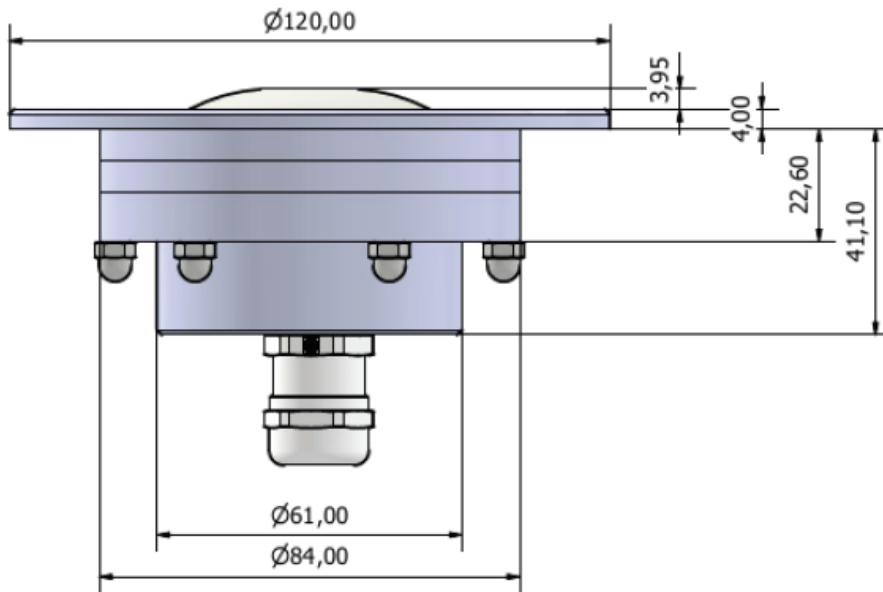

Light distribution SF (TLOF, green)

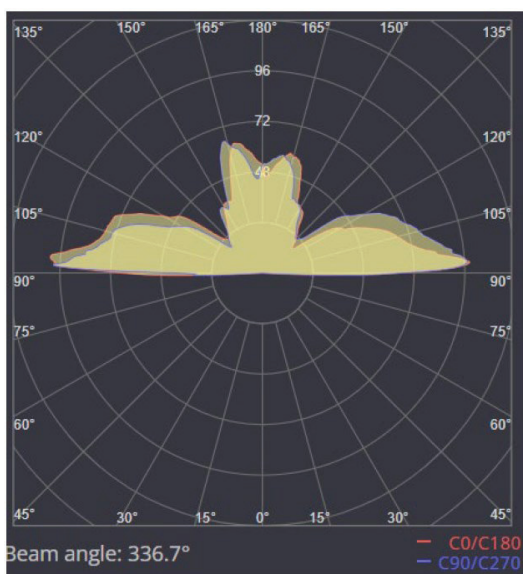

Light distribution SF (FATO, white)

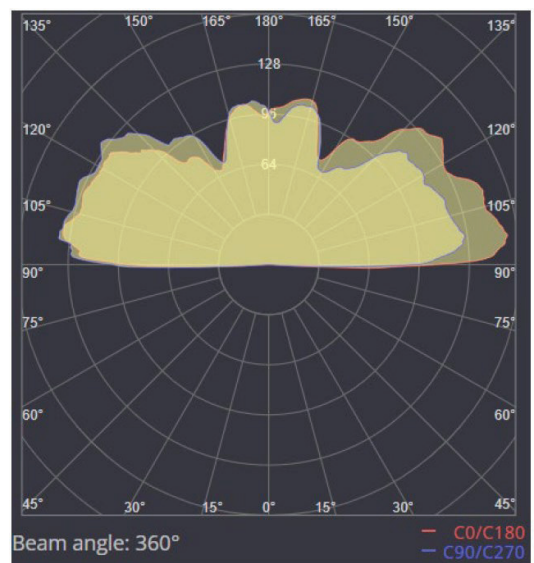



Hugentobler Spezialleuchten AG

Brunnenwiesenstrasse 14

CH - 8570 Weinfelden

Tel. +41 71 626 20 40

info@spezialleuchten.ch

www.spezialleuchten.ch



Signalling and alarm lights



Special lights for aviation and navigation



Tunnel safety lights