

Elevated LED light Type EL622D ZHR

This microprocessor-controlled, omnidirectional elevated light was developed for heavy duty use along taxiways. It is used as a taxiway edge light. The requirements according to EASACS-ADR-DSN Issue 6 (released March 29, 2022) are fulfilled.

The EL622D is controlled by constant input voltage with PowerLineControl PLC.

Lights with PLC are controlled and monitored via the lighting bus system BBS. The light intensity is programmed according to the specifications, and operating data from the light is continuously transmitted to the BBS.



Technical Data

Casing	Aluminium casting, powder coated RAL 5005 or RAL 3020
Protection	IP 67
Weight	1.7 kg (without base plate)
Source of light	LED
Color of light	blue or red
Temperature	-25°C to +70°C
Fixation	clamped
Tension	48V AC max.
Power Pmax.	7.5W
Light intensity	blue 3.15 cd red 10 cd

Execution and Accessory

Cable length	max. 250 m
Accessory	tube support with pre-determined breaking point, base plate, cable bracket, assembly aids for maintenance

Order Information

Order number	EL622D-TEL/ZHR-c-P-C
Color (c)	b blue r red
Type	P parallel system
Controls	C by PLC (BBS required)

Side view

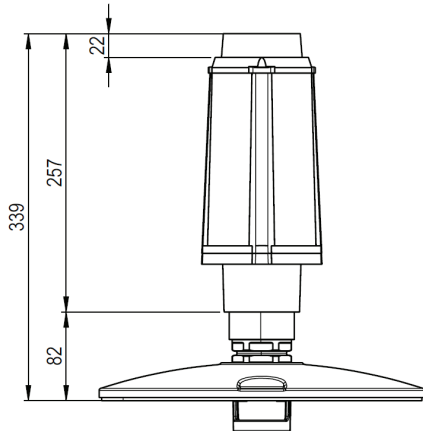

Base plate

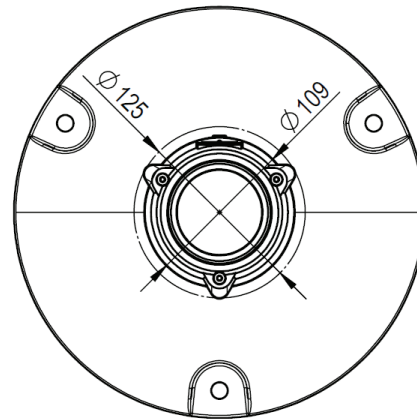

Hugentobler Spezialleuchten AG

Brunnenwiesenstrasse 14

CH - 8570 Weinfelden

Tel. +41 71 626 20 40

info@spezialleuchten.ch

www.spezialleuchten.ch



Signalling and alarm lights



Special lights for aviation and navigation



Tunnel safety lights

Elevated LED light Type EL622D ARMA

This microprocessor-controlled, omnidirectional elevated light was developed for heavy duty use along taxiways. It is used as a taxiway edge light. The requirements according to EASA CS-ADR-DSN Issue 6 (released March 29, 2022) are fulfilled.

Thanks to the programmable power supply unit, the brightness levels can be adapted very flexibly to the customer's needs depending on the input voltage.



Technical data

Casing	Aluminium casting, powder coated RAL 5005
Protection	IP 67
Weight	1.7 kg (without base plate)
Source of light	LED
Color of light	blue
Temperature	-25°C to +70°C
Fixation	clamped
Tension	parallel circuit 7.5 - 48V AC max.
Brightness levels	10%, 30%, 100%
Power Pmax.	7.5W
Light intensity	blue 3.15 cd

Execution and Accessory

Accessory	Tube support with pre-determined breaking point, base plate, cable bracket, transformer, assembly aids for maintenance
------------------	--

Order Information

Order number	EL622D-TEL/ARMA-b-P-0
Color	b blue
Type	P parallel system
Controls	0 voltage controlled

Side view

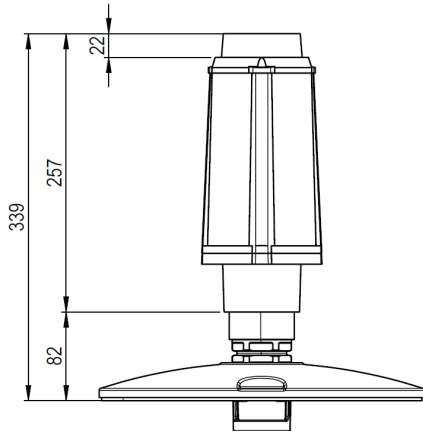

Base plate

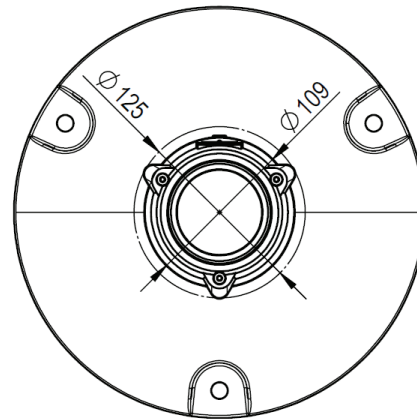

Hugentobler Spezialleuchten AG

Brunnenwiesenstrasse 14

CH - 8570 Weinfelden

Tel. +41 71 626 20 40

info@spezialleuchten.ch

www.spezialleuchten.ch



Signalling and alarm lights



Special lights for aviation and navigation



Tunnel safety lights